

THE SURVEYORS FOR THE CITY OF AKRON DETERMINED THE RR R/W IN PART BY USING THE LOCATION OF AN EXISTING CULVERT IN THIS AREA. (DENOTED ON THE CITY OF AKRON SURVEY MAP) THAT CULVERT HAS BEEN REMOVED

THE ACCURATE LOCATION OF THE RAILROAD APPEARS TO BE NEBULOUS AND THE ESTABLISHMENT OF THE RIGHT-OF-WAY BASED ON EXISTING MONUMENTATION IN ONE SECTION/AREA APPEARS, WITHOUT PATTERN, TO HAVE AN ADVERSE AFFECT ON THE ACCURATE LOCATION IN OTHER AREAS WHEN RAILROAD, DETAIL INFORMATION FROM THE AVAILABLE EVALUATION SHEET (DATED 1916-1926) IS APPLIED

I RE-ESTABLISHED THE R/W OF THE RR USING THREE CITY OF AKRON MONUMENTS FOUND ON THE EASTERLY R/W AS DETERMINED BY THE CITY OF AKRON AND THE LOCATION OF THE BACKWALLS OF A TRESSLE (FOR STATIONING) AT STA 1417.95.3 & 1418+51.0 (ABOUT 2200' NORTH OF BURTON STATION)

CURVE	CHD BEARING	CHORD	RADIUS	ARC	DELTA
C1 (4.438A)	S07°01'30"E	590.24'	1959.86'	592.49'	17°19'16"
C2 (1.238A)	S02°53'18"E	309.13'	1959.86'	309.45'	9°02'48"
C3 (3.200A)	S11°32'51"E	282.79'	1959.86'	283.04'	8°16'29"

THERE APPEARS TO BE A DIFFERENCE OF ABOUT 4-1/2' IN THE RAILROAD LOCATION (EAST-WEST) BETWEEN SURVEYORS SCHWARTZ & DUDLEY

5/8" PIN USED BY SCHWARTZ TO ESTABLISH RR

5/8" PIN USED BY DUDLEY TO ESTABLISH RR

1475+67.7 C.T.

"TEMPLE" PIN FD 1.32'E

"TEMPLE" PIN FD 3.55'E

1467+95.2 T.C.

CITY OF AKRON ALUMINUM MON FOUND/USED

1" PIPE FD 3.87'E

CITY OF AKRON ALUMINUM MON USED

1463+71.2 C.T.

SURVEY OF THIS PARCEL BY AZTECH APPEARS TO INDICATE THE CITY OF AKRON MONUMENT ON THE RR R/W. A 1" PIPE 3.36" N OF THE R/W AND A 1273.24' CENTERLINE RADIUS

"AZTECH" PIN 5/8" PIN "CHATHAM" 2.42' N & 3.34' W OF CITY OF AKRON MON

CITY OF AKRON ALUMINUM MON FD 0.08'E

**STATE OF OHIO
COUNTY OF GEAUGA
TOWNSHIP OF CLARIDON
LOT 2 SECTION 15 EAST SURVEY**

BEING A PART OF PROPERTY NOW OR FORMERLY OWNED BY FREDERICK E. & SHERILL HATCH AS RECORDED IN DEED 1267-464 LYING EAST OF THE CENTERLINE OF OLD STATE ROAD

- IRON PIN/PIPE FD AS DESCRIBED
 - 5/8"x30" IRON REROD W/ID CAP SET "JN FRANCIS S6916 3991281"
 - CITY OF AKRON ALUMINUM MONUMENT FD
- 381.25'C CALCULATED DISTANCE (CH=CHAINS)
381.25'M MEASURED DISTANCE
381.25'R RECORD DISTANCE

SURVEY PLAT & LEGAL DESCRIPTION APPROVED PER R.C. 319.251
R.S. 12.27.05
OFFICE OF THE REGISTERED GEauga COUNTY ENGINEER

I HERBY CERTIFY THAT THIS MAP IS A REPRESENTATION OF AN ACTUAL SURVEY PERFORMED BY ME IN DECEMBER, 2005 AND IS AN OPINION, BASED ON A COMPARISON OF AVAILABLE INFORMATION AND THE PHYSICAL POSITION OF EVIDENCE LOCATED IN ACCORDANCE WITH O.R.C. 4733-37.

JOHN N. FRANCIS PROFESSIONAL SURVEYOR S6916
157 PEW CT. N.E. WARREN, OHIO 44481 330-399-1281

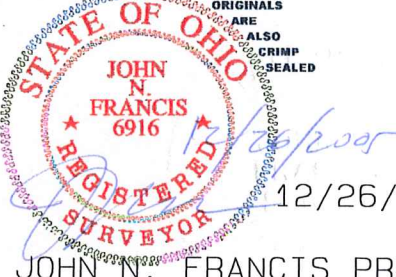

Hatch
picked up 12-27-05
12-095187
Vol. 1784-557

DESCRIPTION OF 1.238 ACRES

SITUATED in the State of Ohio, County of Geauga, Township of Claridon, Lot 2, Section 15, East Survey and being a part of property now or formerly owned by Frederick E. & Sherill Hatch, recorded in deed 1267-464 which lies east of the centerline of Old State Road/S.R. 608.

BEGINNING at a 1 inch pin found in a monument box, in the centerline of Old State Road/S.R. 608(66');

THENCE South 21°05'50" East and along the centerline, a distance of 6796.99 feet to the southwest corner of M. J. Pillot(Deed 1726-979), and the **TRUE PLACE OF BEGINNING** for the parcel being described

THENCE North 88°58'18" East, along the south line of Pillot and passing through a Duddley-capped 5/8 inch pin found at 34.24 feet(N=674117.04, E=2350834.53, EL=1128.83), a distance of 270.12 feet to a Duddley-capped pin found at the southeast corner of Pillot;

THENCE North 02°16'12" West, and along the marked east line of Pillot, a distance of 201.46 feet to a Temple-capped 5/8 inch pin found at the marked southeast corner of M. M. Moizuk(Deed 1544-1207), common with the marked corner of Pillot;

THENCE North 04°10'56" West, and along the marked east line of Moizuk, a distance of 126.15 feet to a Temple-capped pin found at a jog in Moizuk;

THENCE North 88°55'50" East, and along a south line of Moizuk, a distance of 113.91 feet to a 5/8 inch iron rered set at a southeast corner of Moizuk, on the westerly line of Geauga County Park District(deed 1442-709), 3.55 feet west of a Temple-capped pin found(on a line extended), to a point of cusp on a curve concave to the east having a radius of 1959.86 feet, a central angle of 9°02'48" and an arc distance of 309.45 feet;

THENCE southerly along said curve and along the west line of said Park District, subtended by a chord which bears South 02°53'18" East, a chord distance of 309.13 feet to a 5/8 inch iron rered set;

THENCE thence South 67°57'33" West, through the lands now or formerly owned by Hatch and passing through a 5/8 inch rered set 33.00 feet from the centerline, a distance of 365.91 feet to a point on the centerline of Old State Road/S.R. 608;

THENCE North 21°05'50" West and along said centerline, a distance of 120.00 feet to the **TRUE PLACE OF BEGINNING**, containing **1.238 acres**, more or less, as surveyed by John N. Francis, Professional Surveyor S6916, in December, 2005. North and given coordinates are Grid, based on Ohio State Plane System 3401(combined constant 1:0.9999133), Nad83/NGVD29 and constrained using a Geauga County Engineer, "GCE" capped, pin found at the southeast corner of Claridon Township. All monument set or found are 5/8 inch and made of para-magnetic material, unless otherwise stated. All rered set are 30 inches long and I.D. Capped, "JN FRANCIS S6916 3991281".

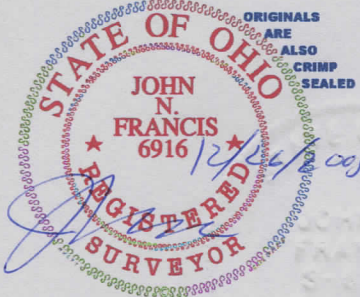

rev 12/26/2005

SURVEY PLAT & LEGAL DESCRIPTION
APPROVED PER R.C. 315.251

R.S. 12/27/05
OFFICE OF THE *Revised*
GEAUGA COUNTY ENGINEER

DESCRIPTION OF 3.200 ACRES

SITUATED in the State of Ohio, County of Geauga, Township of Claridon, Lot 2, Section 15, East Survey and being a part of property now or formerly owned by Frederick E. & Sherill Hatch, recorded in deed 1267-464 which lies east of the centerline of Old State Road/S.R. 608.

BEGINNING at a 1 inch pin found in a monument box, in the centerline of Old State Road/S.R. 608(66');

THENCE South 21°05'50" East and along the centerline, a distance of 6916.99 feet(6796.99'+120.00') to the **TRUE PLACE OF BEGINNING** for the parcel being described

THENCE North 67°57'33" East, through lands now or formerly owned by Hatch and through a 5/8 inch reroed set at 33.00 feet, a distance of 365.91 feet to a 5/8 inch reroed set on the westerly line of Geauga County Park District(deed 1442-709), at a point of cusp on a curve concave to the east having a radius of 1959.86 feet, a central angle of 8°16'29" and an arc distance of 283.04 feet;

THENCE southerly along said Park District and curve and being subtended by a chord which bears South 11°32'51" East, a chord distance of 282.79 feet to a 5/8 inch iron reroed set at the point of tangency, bearing South 74°19'50" West, a distance of 100.00 feet from a City of Akron, Aluminum monument found;

THENCE South 15°41'08" East tangent to said curve and continuing along the west line of said Park District, a distance of 200.62 feet to a 5/8 inch iron reroed set at the northeast corner of C. E. & G. H. Baker(Deed 1782-2853)and bearing South 88°17'52" West, a distance of 3.87 feet from a 1 inch pipe found;

THENCE South 88°17'52" West, along the north line of Baker and passing through a 1 inch pipe found 35.00 feet from the centerline, a distance of 318.08 feet to the centerline of Old State Road/S.R. 608, the northwest corner of Baker and bearing North 24°35'05" West, a distance of 2452.56 feet from a Geauga County Engineer's capped 5/8 inch pin found at the common corner of Huntsburg, Middlefield, Burton and Claridon townships(N=671431.89, E=2351995.93, Elev=1138.94);

THENCE North 21°05'50" West and along said centerline, a distance of 366.95 feet to the **TRUE PLACE OF BEGINNING**, containing **3.200 acres**, more or less, as surveyed by John N. Francis, Professional Surveyor S6916, in December, 2005. North and given coordinates are Grid, based on Ohio State Plane System 3401(combined constant 1:0.9999133), Nad83/NGVD29 and constrained using a Geauga County Engineer, "GCE" capped, pin found at the southeast corner of Claridon Township. All monument set or found are 5/8 inch and made of para-magnetic material, unless otherwise stated. All reroed set are 30 inches long and I.D. Capped, "JN FRANCIS S6916 3991281".

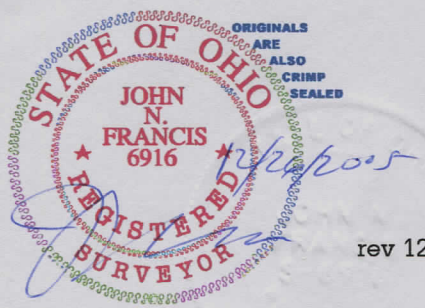

rev 12/26/2005

SURVEY PLAT & LEGAL DESCRIPTION
APPROVED PER R.C. 315.251
R.S. 12/27/05
OFFICE OF THE Revised
GEAUGA COUNTY ENGINEER

DESCRIPTION OF 4.438 ACRES

SITUATED in the State of Ohio, County of Geauga, Township of Claridon, Lot 2, Section 15, East Survey and being a part of property owned by Frederick E. & Sherill Hatch, recorded in deed 1267-464 which lies east of the centerline of Old State Road/S.R. 608.

BEGINNING at a 1 inch pin found in a monument box, in the centerline of Old State Road/S.R. 608(66');

THENCE South 21°05'50" East and along the centerline, a distance of 6796.99 feet to the southwest corner of M. J. Pillot(Deed 1726-979), and the **TRUE PLACE OF BEGINNING** for the parcel being described

THENCE North 88°58'18" East, along the south line of Pillot and passing through a Duddley-capped 5/8 inch pin found at 34.24 feet(N=674117.04, E=2350834.53, EL=1128.83), a distance of 270.12 feet to a Duddley-capped pin found at the southeast corner of Pillot;

THENCE North 02°16'12" West, and along the marked east line of Pillot, a distance of 201.46 feet to a Temple-capped 5/8 inch pin found at the marked southeast corner of M. M. Moizuk(Deed 1544-1207), common with the marked corner of Pillot;

THENCE North 04°10'56" West, and along the marked east line of Moizuk, a distance of 126.15 feet to a Temple-capped pin found at a jog in Moizuk;

THENCE North 88°55'50" East, and along a south line of Moizuk, a distance of 113.91 feet to a 5/8 inch iron rered set at a southeast corner of Moizuk, on the westerly line of Geauga County Park District(deed 1442-709), 3.55 feet west of a Temple-capped pin found(on a line extended), at the point of cusp on a curve concave to the east having a radius of 1959.86 feet, a central angle of 17°19'16" and an arc distance of 592.49 feet;

THENCE southerly along said curve and along the west line of said Park District, subtended by a chord which bears South 07°01'30" East, a chord distance of 590.24 feet, to a 5/8 inch iron rered set at the point of tangency, bearing South 74°19'50" West, a distance of 100.00 feet from a City of Akron, Aluminum monument found;

THENCE South 15°41'08" East tangent to said curve and continuing along the west line of said Park District, a distance of 200.62 feet to a 5/8 inch iron rered set at the northeast corner of C. E. & G. H. Baker(Deed 1782-2853)and bearing South 88°17'52" West, a distance of 3.87 feet from a 1 inch pipe found;

THENCE South 88°17'52" West, along the north line of Baker and passing through a 1 inch pipe found 35.00 feet from the centerline, a distance of 318.08 feet to the centerline of Old State Road/S.R. 608, the northwest corner of Baker and bearing North 24°35'05" West, a distance of 2452.56 feet from a Geauga County Engineer's capped 5/8 inch pin found at the common corner of Huntsburg, Middlefield, Burton and Claridon townships(N=671431.89, E=2351995.93, Elev=1138.94);

THENCE North 21°05'50" West and along said centerline, a distance of 486.95 feet to the **TRUE PLACE OF BEGINNING**, containing **4.438 acres**, more or less, as surveyed by John N. Francis, Professional Surveyor S6916, in December, 2005. North is grid based on Ohio State Plane System 3401(combined constant 1:0.9999133), Nad83/NGVD29 and constrained using a Geauga County Engineer, "GCE" capped, pin found at the southeast corner of Claridon Township. All monument set or found are 5/8 inch and made of para-magnetic material, unless otherwise stated. All rered set are 30 inches long and I.D. Capped, "JN FRANCIS S6916 3991281".



rev 12/26/2005

SURVEY PLAT & LEGAL DESCRIPTION
APPROVED PER R.C. 315.251

R.S. 12/27/05
OFFICE OF THE *Revised*
GEAUGA COUNTY ENGINEER